

MAYFAIR PERFORMANCE

PART NO.
137-9257

TITLE:

MAYFAIR 1-1/4 TIE BAR

www.mayfairperformance.com

ITEM NO.	PART NUMBER	DESCRIPTION	QTY.
1	137-9223	ROD END, MALE	2
2	137-9225	CLEVIS	2
3	137-9231	BOLT, CLEVIS	2
4	137-9245	BUSHING, COMPRESSION	1
5	137-9547	BUSHING, CLEVIS - 1/2 ID	2
6	90050AN-STSS	WASHER, 1/2 AN	4
7	90050FN-FNSS	NUT, NYLON, 1/2"-20	2
8	90075FP-HNSS	NUT, JAM - 3/4-16	1

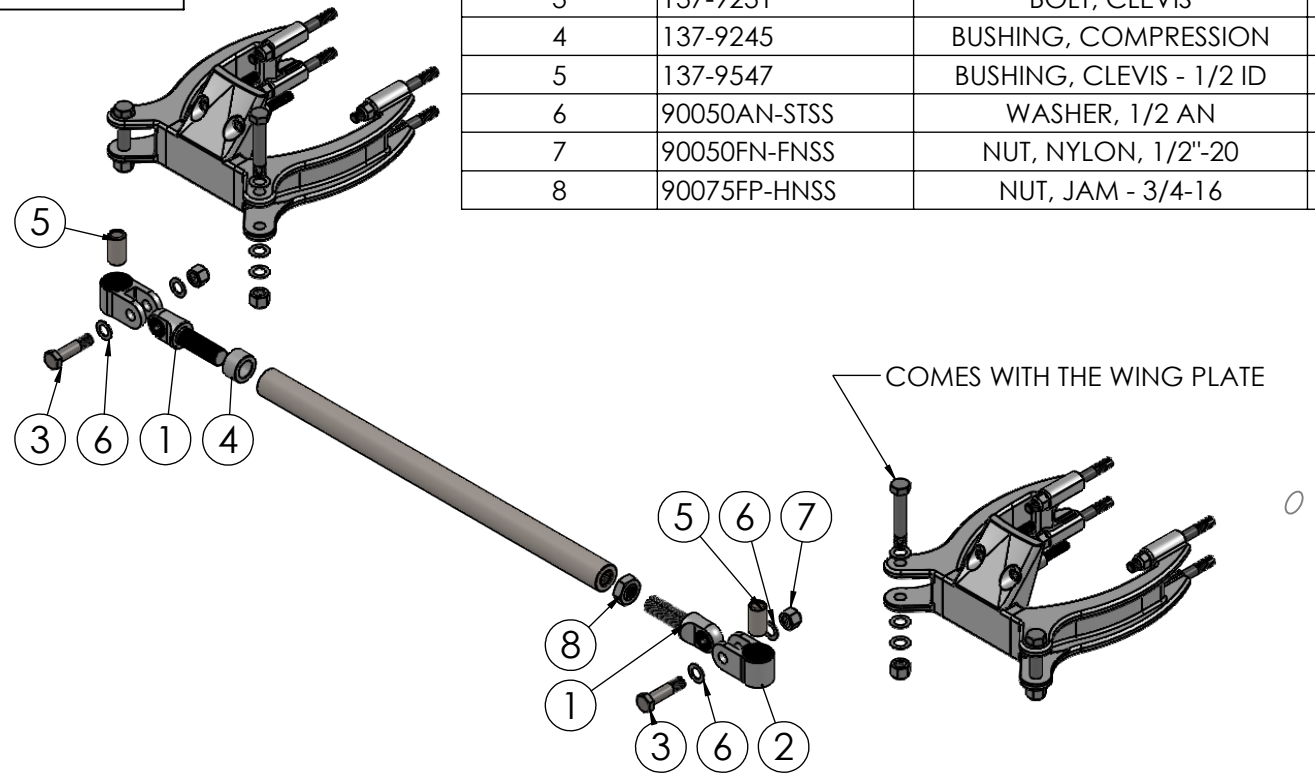

INSTALLATION INSTRUCTIONS:

- 1) **VERY IMPORTANT, APPLY ANTI-SIEZE TO ALL THREADS!**
- 2) SLIDE #4 WHITE COMPRESSION BUSHING OVER #1 MALE ROD END.
- 3) SCREW ROD END ALL THE WAY TILL TIGHT.
- 4) INSTALL #8 JAM NUT ONTO #1 ROD END. THIS WILL BE THE SIDE THE WILL ADJUST THE TIE BAR LENGTH.
- 5) USE #3 BOLTS, #6 WASHERS AND #7 NUTS TO INSTALL #2 CLEVIS'S TO THE ROD ENDS. USE 3/4 WRENCHES TO TIGHTEN THE CLEVIS SO THEY ARE SNUG WITH A SLIGHT DRAG ON THEM.
- 6) INSTALL #5 BUSHINGS INTO BOTH CLEVIS.
- 7) INSTALL THE SOLD SIDE OF THE TIE BAR INTO THE WING PLATE USING THE BOLT ASSEMBLY THE COME WITH THE STEERING KIT.
- 8) SLIDE THE ADJUSTING SIDE INTO THE WING PLATE. REMOVE TO ADJUST THE LENGTH. ONCE DONE. INSTALL WING BOLT ASSEMBLY. USING 3/4 SOCKET AND WRENCH. TORQUE TO 50 FT. LBS..
- 9) USING 1-1/8 CROWS FOOT. TORQUE #8 JAM NUT TO 50 FT. LBS..

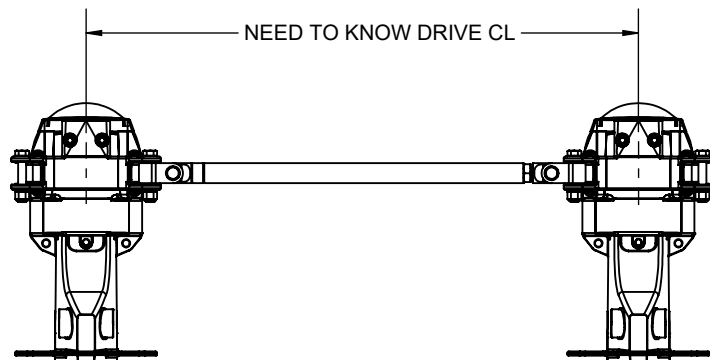

THIS DRAWING IS CONFIDENTIAL AND IS SUPPLIED ON EXPRESS CONDITION THAT IT SHALL NOT BE LENT, COPIED OR DISCLOSED TO ANY OTHER PERSON OR USED FOR ANY OTHER PURPOSE WITHOUT WRITTEN CONSENT OF HARDIN MARINE INC.. BREACH OF THIS CONTRACT WILL HOLD AND IT'S PRINCIPALS LIABLE FOR LOSS AND DAMAGES.