

MAYFAIR PERFORMANCE

PART NO.
137-8687

TITLE:
BRAVO GIMBAL MOUNT TRIM INDICATOR

www.mayfairperformance.com

137-8687 STARBOARD SIDE SHOWN.
PORT SIDE IS 137-8647, ONLY
DIFFERENCE IS #1 137-8648 BRACKET

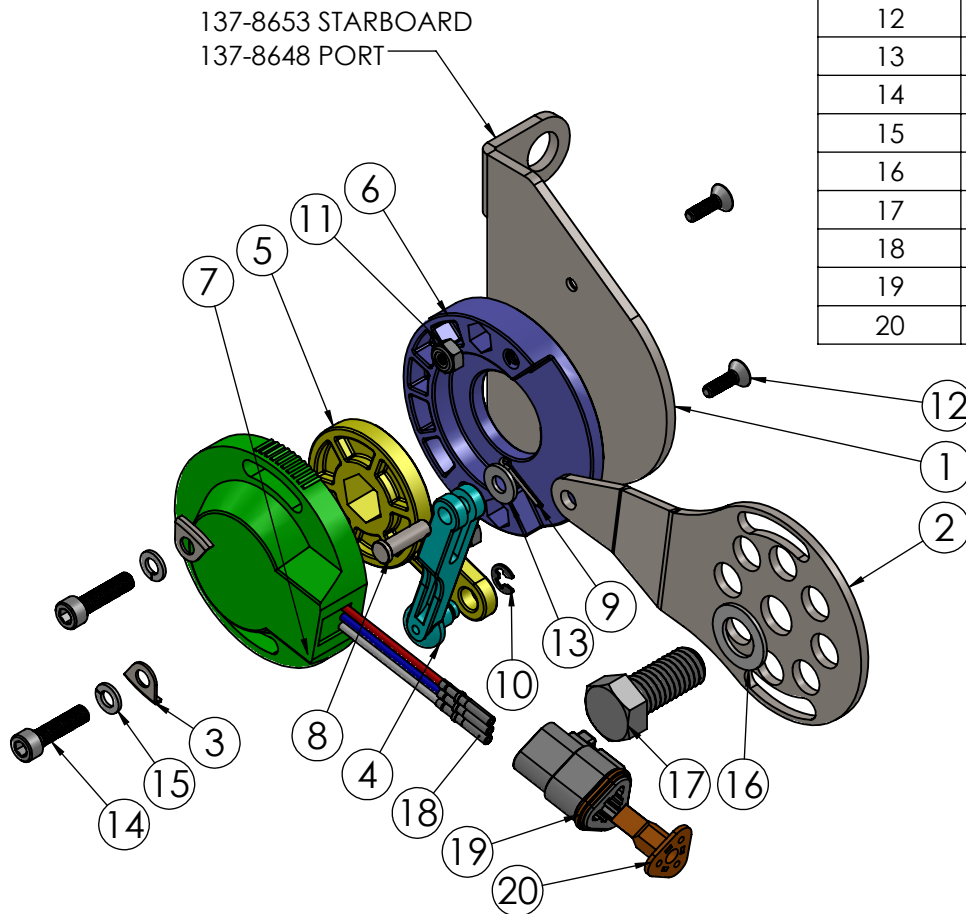

ITEM NO.	PART NUMBER	DESCRIPTION	QTY.
1	137-8653	MOUNT, BRAVO STBD TRIM SENSOR	1
2	137-8654	ARM, BRAVO TRIM ACTUATOR	1
3	525-57008	RETAINER	2
4	525-840843	LINK, ROD	1
5	525-840845	ARM, BRAVO TRIM SENDER	1
6	525-840846	HOUSING, TRIM SENDER	1
7	525-8M0095310	TRIM SENSOR	1
8	525-17-67297	PIN, CLEVIS	1
9	525-18-210711	COTTER PIN	1
10	620-60311	ECLIP, SHIFTER	1
11	90006CN-FN55	NUT, 6-32	2
12	90006C050SFS	BOLT, 6-32 x .50	2
13	90010AN-ST55	WASHER, #10 AN	1
14	90010F075SHS	BOLT, 10-32 x .75	2
15	90010SL-ST55	WASHER, #10	2
16	90043AN-ST55	WASHER, 7/16AN	1
17	90043C100HHS	BOLT, 7/16-14 x 1.00	1
18	137-8628	PIN, FEMALE PLUG	3
19	137-8629	PLUG, FEMALE 3 WAY	1
20	137-8629W	WEDGE, FEMALE 3 WAY PLUG	1

THIS DRAWING IS CONFIDENTIAL AND IS SUPPLIED ON EXPRESS CONDITION THAT IT SHALL NOT BE LENT, COPIED OR DISCLOSED TO ANY OTHER PERSON OR USED FOR ANY OTHER PURPOSE WITHOUT WRITTEN CONSENT OF HARDIN MARINE INC.. BREACH OF THIS CONTRACT WILL HOLD AND IT'S PRINCIPALS LIABLE FOR LOSS AND DAMAGES.

MAYFAIR PERFORMANCE

PART NO.
137-8687

TITLE: BRAVO ELECTRONIC TRIM SENDER

www.mayfairperformance.com

THIS DRAWING IS CONFIDENTIAL AND IS SUPPLIED ON EXPRESS CONDITION THAT IT SHALL NOT BE LENT, COPIED OR DISCLOSED TO ANY OTHER PERSON OR USED FOR ANY OTHER PURPOSE WITHOUT WRITTEN CONSENT OF HARDIN MARINE INC.. BREACH OF THIS CONTRACT WILL HOLD AND IT'S PRINCIPALS LIABLE FOR LOSS AND DAMAGES.

WARNING:
ATTACHING POWER TO ANY OTHER WIRE THAN THE RED OR GREY WIRE WILL PERMENANTLY DAMAGE THE SENDER AND DASH PANEL.

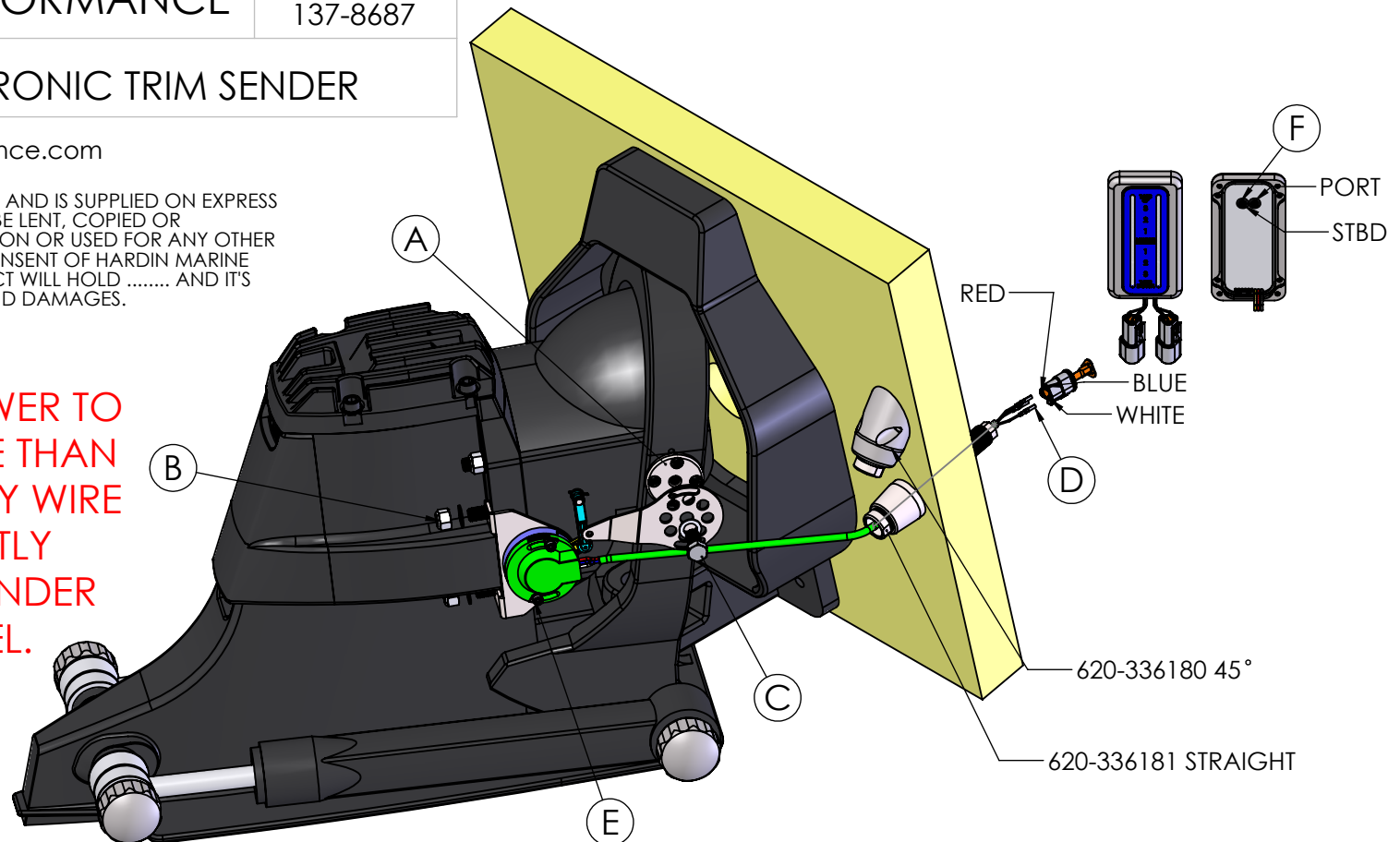

INSTALLATION INSTRUCTIONS:

- 1) THIS KIT WILL ONLY WORK WITH MERCURY HP GIMBLE THAT HAS THE STAINLESS PIN HINGE FIG. A.
- 2) THE SENSOR AND ARM COMES PREASSEMBLED. STARBOARD SIDE SHOWN. PORT SIDE IS THE SAME INSTRUCTIONS.
- 3) IF STEERING RAMS ARE IN THE WAY, CAREFULLY REMOVE THEM.
- 4) REMOVE EXISTING NUTS, FIG. B. SLIDE BRACKET ASSEMBLY OVER STUDS. USING 5/8 SOCKET REINSTALL NUTS AND TORQUE TO 45 FT LBS..
- 5) LOWER OUTDRIVE TO THE LOWEST POSITION. INSTALL THE BRACKET TO THE PIVOT PIN, FIG. C, USING 5/8 SOCKET, SNUG BRACKET.
- 6) RAISE AND LOWER DRIVE TO PROPERLY POSITION THE PIVOT PIN BRACKET. YOU WANT TO MAKE SURE THE SENSOR ARM DOES NOT STOP WHILE THE DRIVE CONTINUES TO MOVE. MOVE SIDE TO SIDE TO MAKE SURE NO BIND IN THE BRACKET.
- 7) RUN THE SENDER WIRE TO ONE OF THE SHOWN THRU HULLS, SOLD SEPERATELY.
- 8) THE SENDERS COME WITH THE MALE TERMINAL ENDS ON THEM, FIG. D. SEE 137-8612 WIRE INFORMATION. IF SINGLE DRIVE , SPLICE BOTH WIRES FROM DASH PANEL TOGETHER TO MAKE ONE PLUG. CONNECT TO DASH WITH EITHER 137-8705 30' OR 137-8706 40' WIRE HARNESSSES.
- 9) LOWER THE DRIVE ALL THE WAY DOWN. USING 5/32 ALLEN KEY, LOOSEN SENDER BOLTS, FIG. E. ROTATE THE SENDER COUNTER CLOCKWISE UNTIL JUST THE BOTTOM LIGHT ON THE DASH PANEL IS LIT.
- 10) RAISE OUTDRIVE.
- 11) USING 1/16 ALLEN KEY REMOVE THE BACK COVER. USING A SMALL FLAT BLADE SCREWDRIVER, CAREFULLY ROTATE THE SCREWS COUNTER CLOCKWISE FIG. F. SOME LIGHTS WILL TURN OFF. NOW TURN THE SCREW CLOCKWISE TILL THE TOP LIGHT BECOMES ILLUMINATED.
- 12) CYCLE DRIVE UP AND DOWN TO MAKE SURE DASH PANEL IS ILLUMINATED THE FULL TRAVEL. NOW DO TO THE OTHER SIDE. ONCE DONE, REINSTALL REAR COVER AND INSTALL DASH PANEL.
- 13) REINSTALL STEERING RAMS. WIRE TIE THE TRIM SENDER TO THE TRIM RAM. MAKE SURE YOU ROTATE THE DRIVE LEFT AND RIGHT AND THE WIRES ARE NOT BINDING OR PULLING THE WIRES.

MAYFAIR PERFORMANCE

PART NO.
137-8613

TITLE:
16-20 AWG FEMALE 3 WIRE PLUG

www.mayfairperformance.com

BOM Table

ITEM NO.	PART NUMBER	DESCRIPTION	QTY.
1	137-8628	PIN. FEMALE PLUG	3
2	137-8629	PLUG, FEMALE 3 WAY	1

GROUND
BLUE WIRE MERC/MAYFAIR 3 WIRE SENDER
BLACK WIRE GEN 2/3 RETRO FIT SENDER

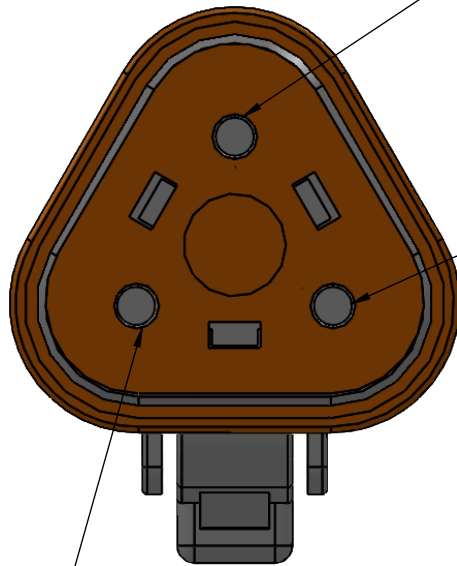

POWER
RED WIRE MERC/MAYFAIR 3 WIRE SENDER
RED WIRE GEN 2/3 RETRO FIT SENDER

SENDER OUTPUT
WHITE WIRE MERC/MAYFAIR 3 WIRE SENDER
YELLOW WIRE GEN 2/3 RETRO FIT SENDER

INSTALLATION NOTES:
 1) COMES INSTALLED ON ALL MAYFAIR 3 WIRE AND RETRO FIT TRIM TAB SENDERS.
 2) ORANGE WEDGE, FIG A. IS NOT SOLD SEPARATELY. COMES WITH 137-8629 FEMALE PLUG.
 3) USE 516-9050-0021 DEUTSCH CRIMP TOOL TO INSTALL 137-8628 PINS.
 4) USING THE COLORS LIST TO THE LEFT. SLIDE PINS INTO PLUG UNTIL THEY CLIP IN. PULL BACK SLIGHTLY TO INSURE PLACEMENT. THIS WIRE COLOR IS ONLY FOR THE MAYFAIR 3 WIRE AND RETRO FIT TRIM TAB SENDERS. MAYFAIR WIRE HARNESSSES USE DIFFERENT WIRE COLORS.
 5) INSTALL ORANGE WEDGE.

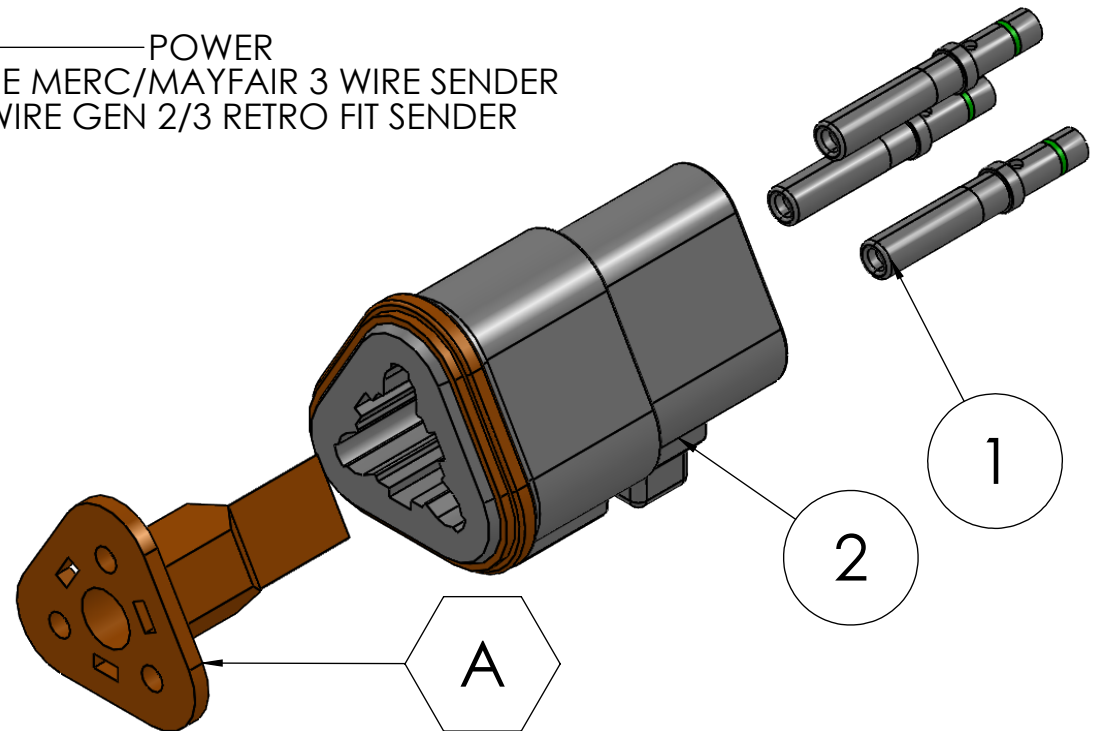

MAYFAIR PERFORMANCE

PART NO.
137-8705

TITLE: 30' WIRE HARNESS FOR MAYFAIR LED DASH
PANEL TO MAYFAIR TRIM SENDER

www.mayfairperformance.com

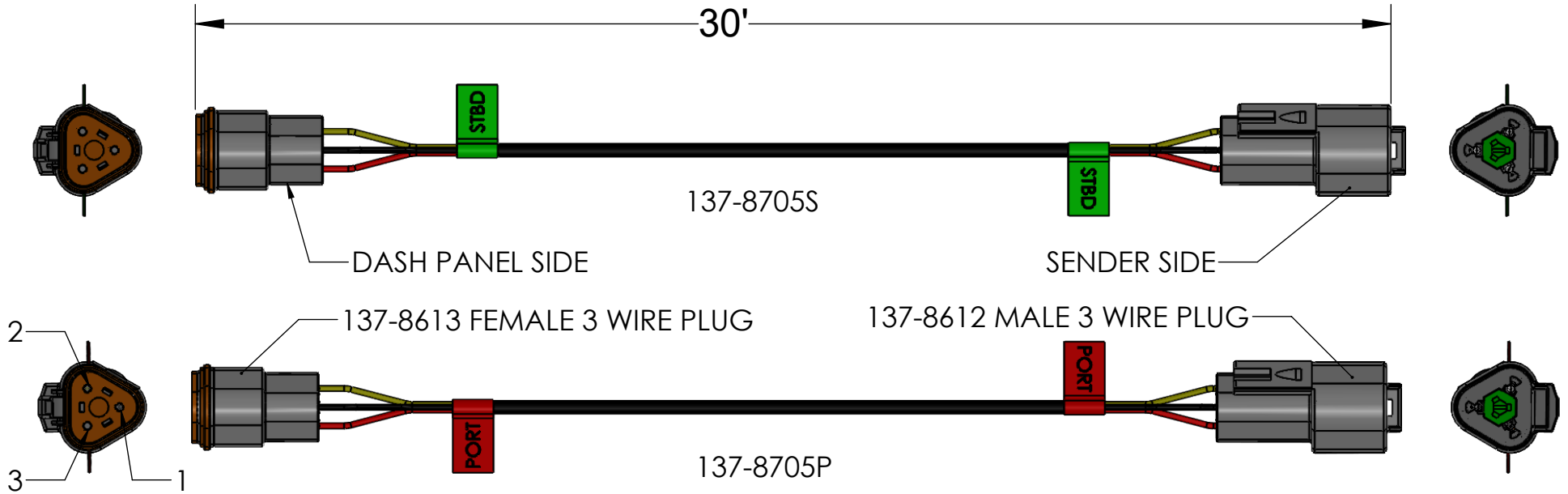

COLOR CODES:

- #1 GROUND - BLACK WIRE
- #2 SENDER - YELLOW WIRE
- #3 POWER - RED WIRE

THESE ARE SOLD EACH. THESE ARE FOR MAYFAIR LED DASH PANELS TO MAYFAIR 3 WIRE AND RETRO FIT TRIM TAB SENDERS. THESE WILL NOT CONNECT TO MERCURY 3 WIRE SENDERS FOR STERNDRIVES, OUTBOARDS OR TRIM TABS. FOR MERCURY TRIM TABS USE 137-8708P OR 137-8708S. FOR MERCURY 3 WIRE STENDRIVE USE 137-8710P OR 137-8710S.

MAYFAIR PERFORMANCE

PART NO.
137-8706

TITLE: 40' WIRE HARNESS FOR MAYFAIR LED DASH
PANEL TO MAYFAIR TRIM SENDER

www.mayfairperformance.com

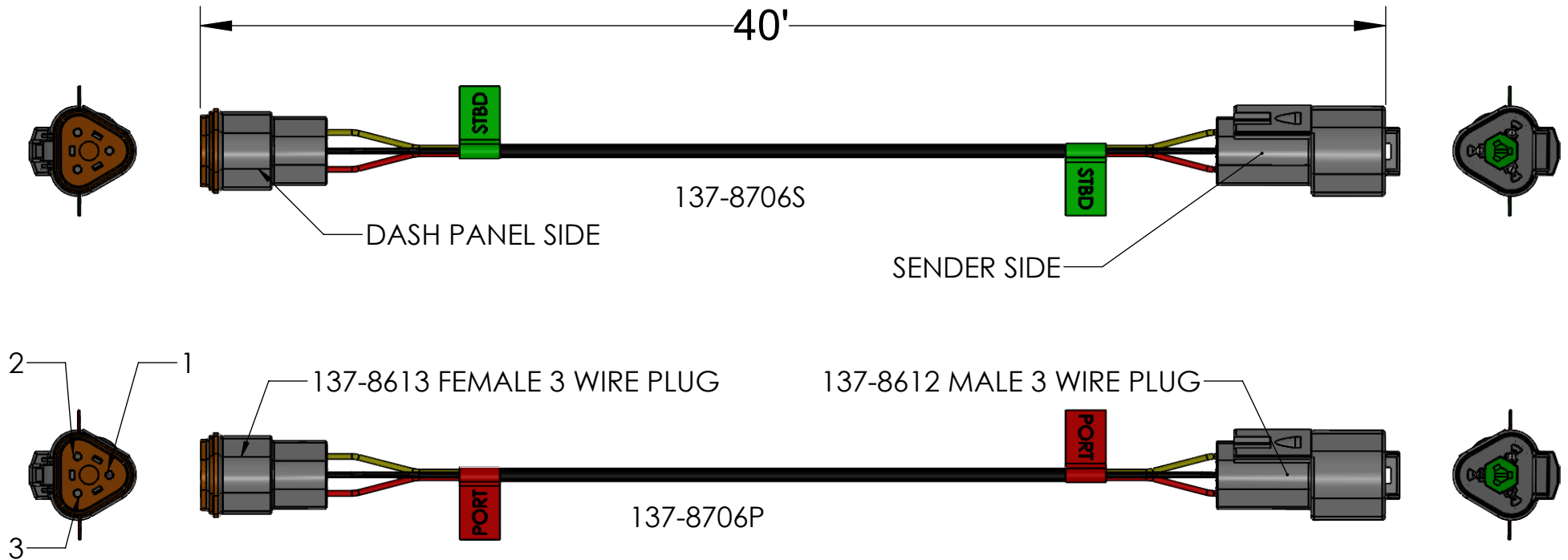

COLOR CODES:

- #1 GROUND - BLACK WIRE
- #2 SENDER - YELLOW WIRE
- #3 POWER - RED WIRE

THESE ARE SOLD EACH. THESE ARE FOR MAYFAIR LED DASH PANELS TO MAYFAIR 3 WIRE AND RETRO FIT TRIM TAB SENDERS. THESE WILL NOT CONNECT TO MERCURY 3 WIRE SENDERS FOR STERNDRIVES, OUTBOARDS OR TRIM TABS. FOR MERCURY TRIM TABS USE 137-8709P OR 137-8709S. FOR MERCURY 3 WIRE STENDRIVE USE 137-8711P OR 137-8711S.

MAYFAIR PERFORMANCE

PART NO.
137-8406

www.mayfairperformance.com

TITLE:
2 SLOT LED TRIM/DRIVE PANEL

ADJUSTING THE LED LIGHT RANGE:

- 1) THESE COME INSTALLED WITH MALE 3 WIRE PLUG ENDS. WE OFFER 137-8705P/S 30" OR 137-8706P/S 40' WIRE HARNESSSES TO CONNECT TO MAYFAIR 3 WIRE AND RETRO FIT TRIM SENDERS. IF YOU ARE USING THIS PANEL WITH MERCURY STERNDRIVE USE 137-8710P/S 30' AND 137-8711P/S 40' WIRE HARDNESSES. IF USING WITH MERCURY TRIM TABS USE 137-8708P/S 30' AND 137-8709P/S 40' WIRE HARNESSSES.
- 2) PANEL COMES SUPPLIED WITH 30' 18GA BLACK, RED AND YELLOW 18GA WIRE, BUTTON CONNECTORS, 5 AMP INLINE HOLDER AND FUSE. EACH PANEL MUST BE WIRE SEPARATELY.
- 3) THE YELLOW DIM WIRE MUST BE CONNECTED TO DASH/INSTRUMENT LIGHT SWITCH ON THE BOAT. DAY MODE THE OPERATE AT FULL BRIGHTNESS. NIGHT MODE WHEN INSTRUMENT LIGHTS ON. LED'S AUTOMATICALLY DIM TO 50% BRIGHTNESS TO PREVENT GLARE AT NIGHT.
- 4) USING 1/16 ALLEN KEY, REMOVE THE BACK COVER.
- 5) MOVE THE DRIVE/TAB ALL THE WAY DOWN.
- 6) ADJUST THE DRIVE/TAB SENDER SO THE BOTTOM LIGHT IS ON ON BOTH SIDES.
- 7) MOVE THE DRIVE/TAB ALL THE WAY UP.
- 8) USING THE PROVIDED SCREWDRIVE, **CAREFULLY** TURN THE ADJUSTMENT ON THE BACK OF THE LED PANEL ALL THE WAY COUNTERCLOCKWISE. SOME OF THE TOP LED'S SHOULD TURN OFF.
- 9) SLOWLY TURN THE ADJUSTING SCREW CLOCKWISE UNTIL THE THE TOP LED LIGHT BEGINS TO ILLUMINATE. PANEL IS ADJUSTED FOR FULL RANGE. NOW ADJUST THE OTHER SIDE.
- 10) REINSTALL REAR COVER. SAME FOR 2, 4 AND 6 SLOT INSTALLATIONS.

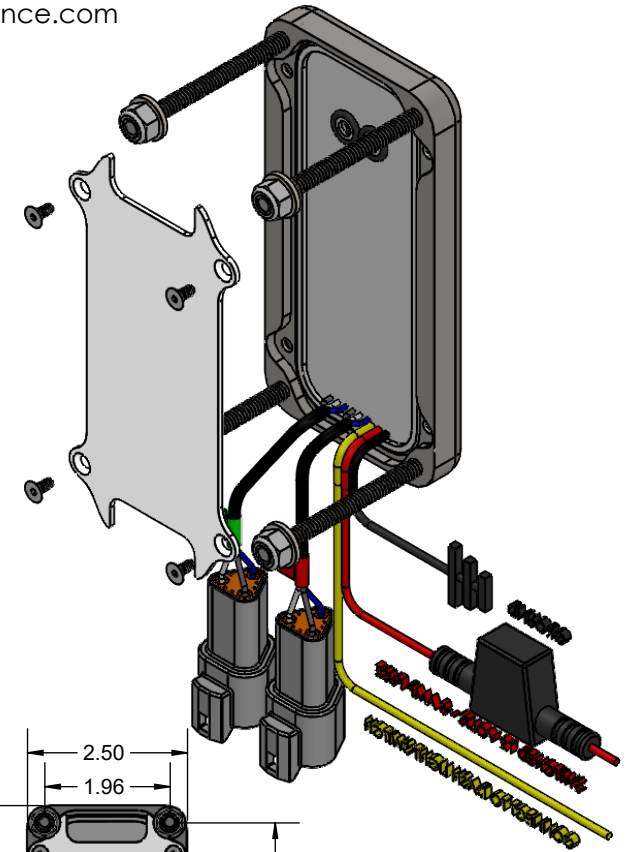

WIRE COLOR CODE:

- 1) BLACK - GROUND
- 2) RED - 12V/ 5AMP FUSED KEYED POWER
- 3) YELLOW - DASH DIM LIGHTS
- 4) BLUE - PORT SENDER GROUND
- 5) WHITE - PORT SENDER SIGNAL
- 6) GREY - PORT SENDER 5V POWER
- 7) BLUE - STBD SENDER GROUND
- 8) WHITE - STBD SENDER SIGNAL
- 9) GREY - STBD SENDER 5V POWER

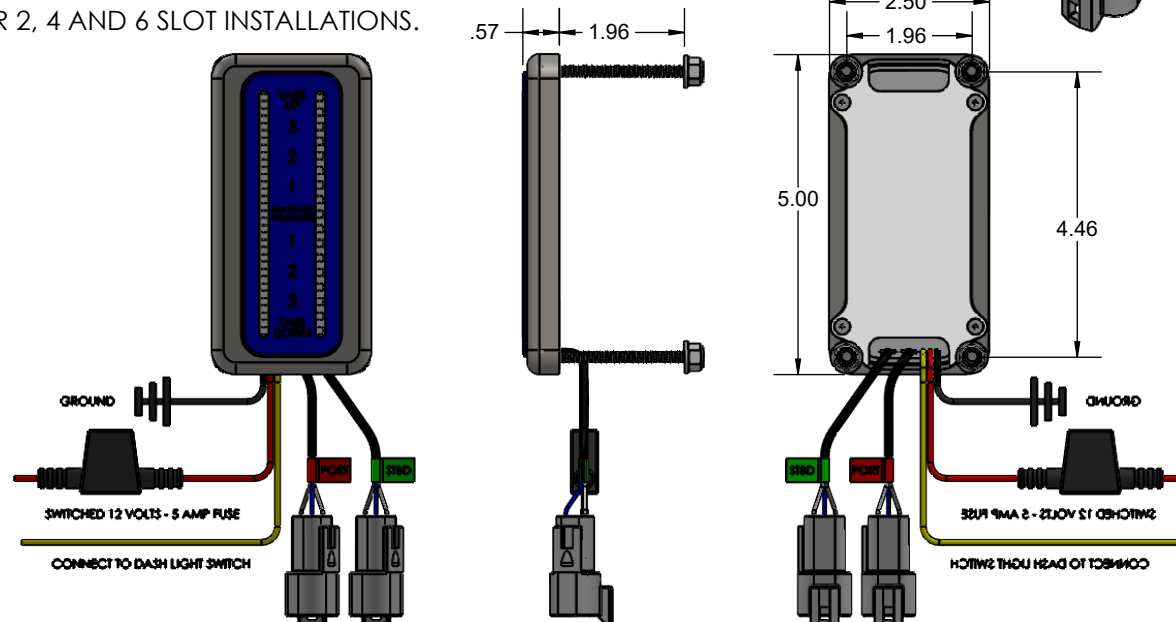

THIS DRAWING IS CONFIDENTIAL AND IS SUPPLIED ON EXPRESS CONDITION THAT IT SHALL NOT BE LENT, COPIED OR DISCLOSED TO ANY OTHER PERSON OR USED FOR ANY OTHER PURPOSE WITHOUT WRITTEN CONSENT OF HARDIN MARINE INC.. BREACH OF THIS CONTRACT WILL HOLD AND IT'S PRINCIPALS LIABLE FOR LOSS AND DAMAGES.