

GEN 7 PLUS SEA PUMP

625-4132

REPLACEMENT REBUILD KITS

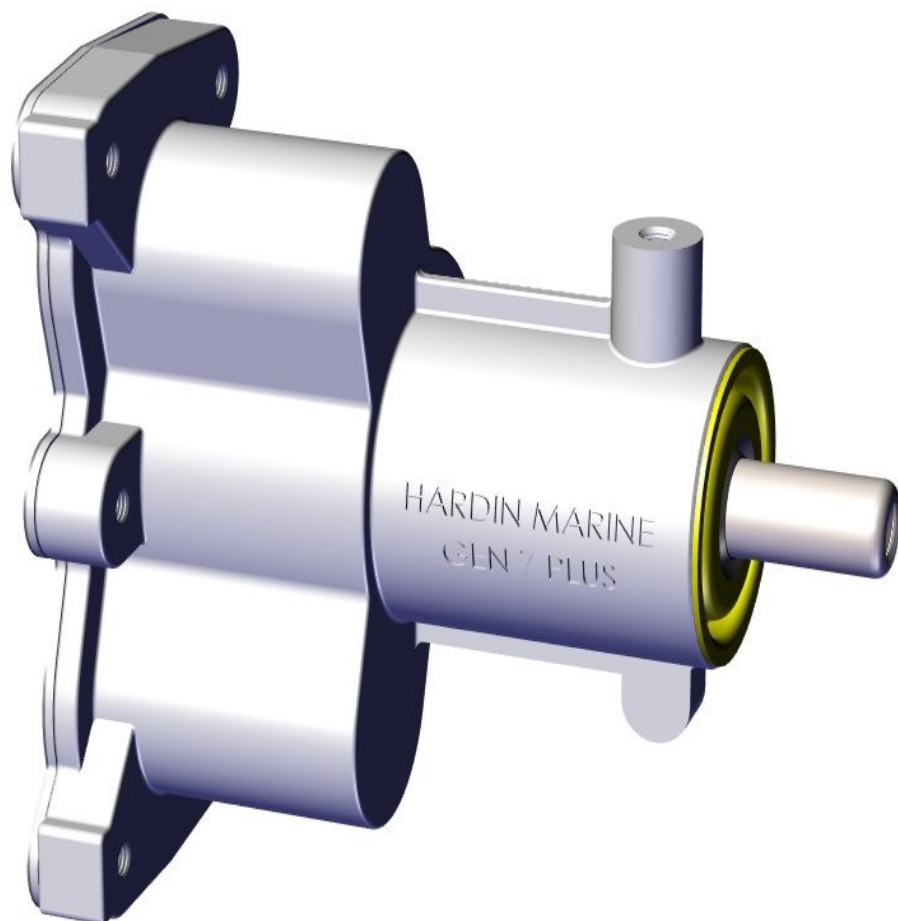

GEN 7 PLUS SEA PUMP

625-4132

REPLACEMENT REBUILD KITS

HARDIN MARINE ADVANTAGE

- **316 STAINLESS STEEL POLISHED BODY.**
- **INTERNAL WEAR PLATE DESIGN PROVIDES A LIFETIME OF SERVICE.**
- **EXTERNAL WEAR PLATE ALLOWS STOCK REAR COVER TO BE REUSED REGARDLESS OF PREVIOUS WEAR DAMAGE.**
- **20% LARGER PUMP SHAFT ACCEPTS MOST POPULAR AFTERMARKET & MERCURISER IMPELLERS**
- **40% LARGER BEARINGS FOR INCREASED LONGEVITY.**
- **DUAL SHAFT SEALS WITH WATER WEEP HOLE.**

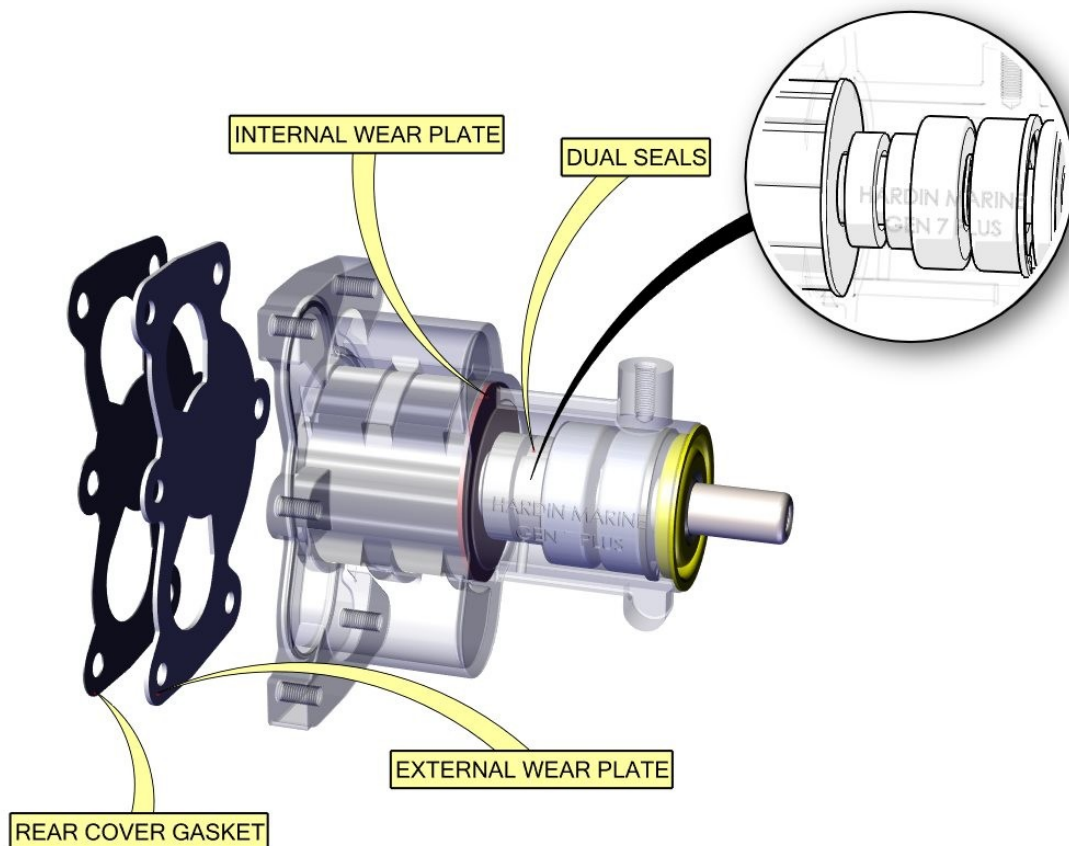

GEN 7 PLUS SEA PUMP

625-4132

REPLACEMENT REBUILD KITS

Step 1

1. Remove the belt.
2. Remove both hoses from the pump.
3. Using a 10 mm socket, remove the 3 bolts as shown.

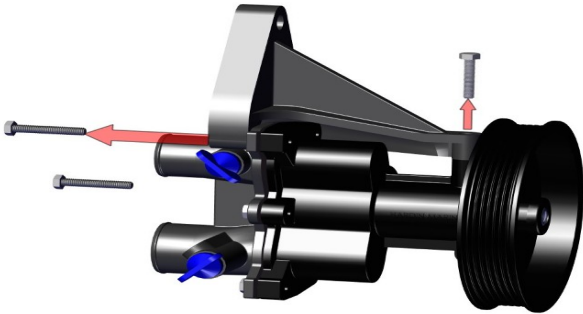

Step 2

1. Using 10 mm socket remove the remaining 4 bolts as shown.
2. Save the rear cover.

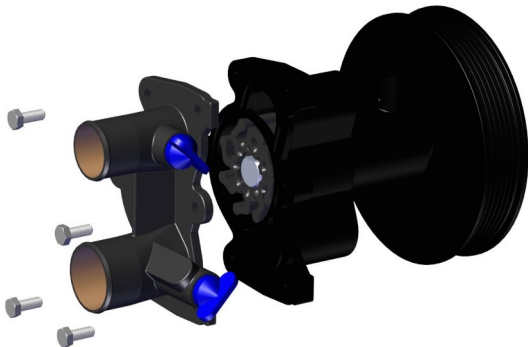

Step 3

1. Install 3/8-16 socket cap screw into the shaft, Fig A.
2. Using OTC-7185 remover. Attached to groove in the pulley, Fig B.
3. Never pull on the outside diameter of the pulley.'

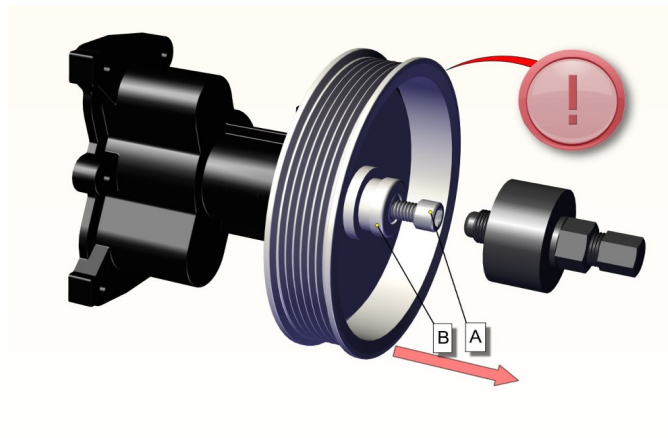

GEN 7 PLUS SEA PUMP

625-4132

REPLACEMENT REBUILD KITS

Step 4

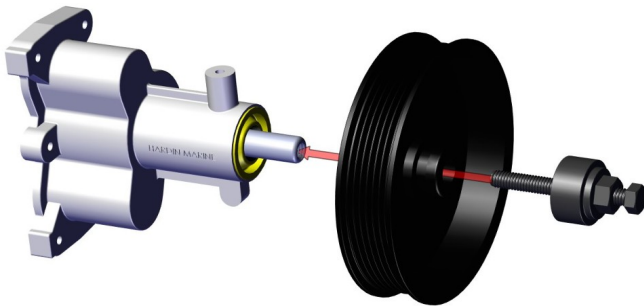

1. Screw OTC-7209 installer into the shaft.
2. Apply grease to the shaft.
3. Install pulley to the same position that it was installed on the stock pump.

Step 5

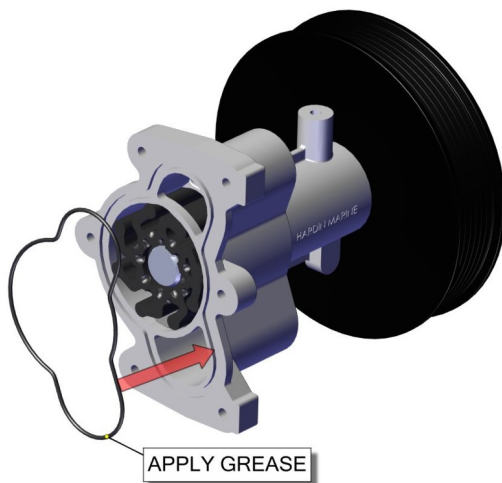

1. Apply white lithium grease to the o-ring and install into the new pump housing groove.
2. Apply white lithium grease to the end of the impeller.

Step 6

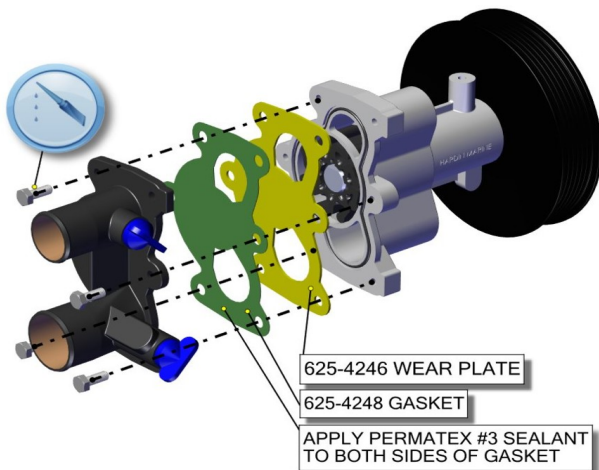

1. Apply Permatex #3 sealant to both sides of gasket, as shown.
2. Apply anti-sieze to the 4 rear cover bolts.
3. Install rear cover, gasket & wear plate as shown.
4. Lightly tighten the bolts.

GEN 7 PLUS SEA PUMP

625-4132

REPLACEMENT REBUILD KITS

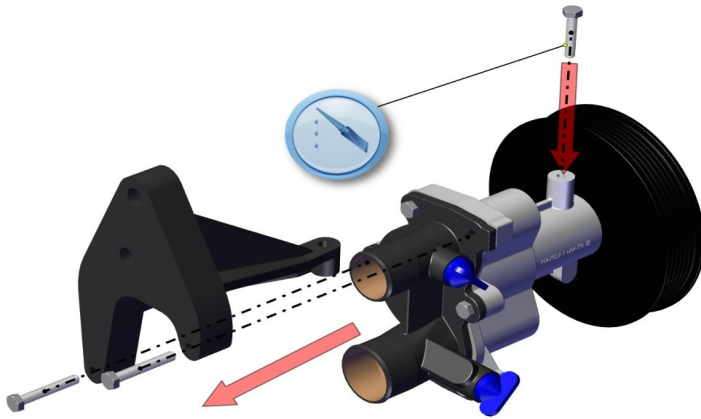

Step 7

1. Apply anti-sieze to the remaining 3 bolts.
2. Install pump as shown.
3. Torque all 7 bolts to 6 ft. lbs..

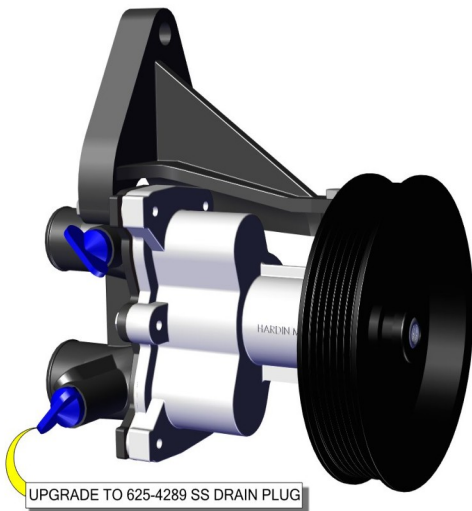

Step 8

1. Attach hoses and belt. Check belt alignment.
2. As a preventive maintenance, replace the plastic Mercury drain plugs with Hardin stainless steel drain plugs.

GEN 7 PLUS SEA PUMP

625-4132

REPLACEMENT REBUILD KITS

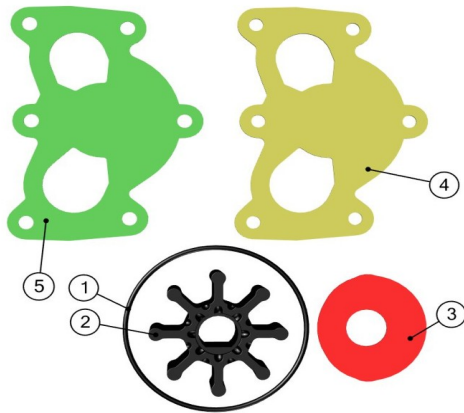

625-4203 STANDARD REBUILD KIT

#	PART #	DESCRIPTION	QTY
1	625-1053	O-RING	1
2	625-4080	IMPELLER	1
3	625-4245	WEAR PLATE-INT.	1
4	625-4246	WEAR PLATE-REAR	1
5	625-4248	GASKET	1

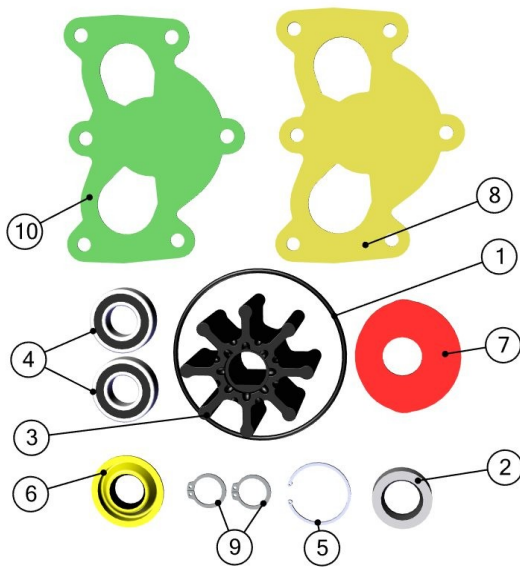

625-4133 MASTER REBUILD KIT

#	PART #	DESCRIPTION	QTY
1	625-1153	O-RING	1
2	625-4234	SEAL	2
3	625-4080	IMPELLER	1
4	625-4302	BEARING	2
5	625-4305	SNAP RING	1
6	625-4304	SEAL	1
7	625-4245	WEAR PLATE-INT	1
8	625-4246	WEAR PLATE-REAR	1
9	625-4302	SNAP RING	2
10	625-4248	GASKET	1

HARDIN
MARINE

11 Industry Dr. Palm Coast, FL 32137
386-445-2500 / FAX 386-445-1122

PART NO.
625-4131/
625-4132

www.hardin-marine.com

TITLE:

GEN 7 HD SEA PUMP

ITEM NO.	PART NUMBER	DESCRIPTION	QTY.
1	625-1153	O-RING, GEN 7	1
2	625-4234	SEAL, GEN 7/8 SEA PUMP	2
3	625-4011	IMPELLER, SEA PUMP	1
4	625-4301	SHAFT, SEA PUMP	1
5	625-4245	WEAR PLATE, INTERNAL	1
6	625-4246	WEAR PLATE, REAR	1
7	625-4248	GASKET, GEN 7	1
8	625-4302	BEARING, SEA PUMP	2
9	625-4303	SNAP RING, SHAFT	2
10	625-4304	SEAL, FRONT	1
11	625-4305	SNAP RING, HOUSING	1
12	625-4308	BODY, GEN 7	1
13	625-4262	PULLEY	1
14	625-4263	HUB, GEN 7 SEA PUMP	1
15	90031AN-STSS	WASHER, 5/16 AN	4
16	90031F075SHS	BOLT, SHCS, 5/16-18x3/4	4

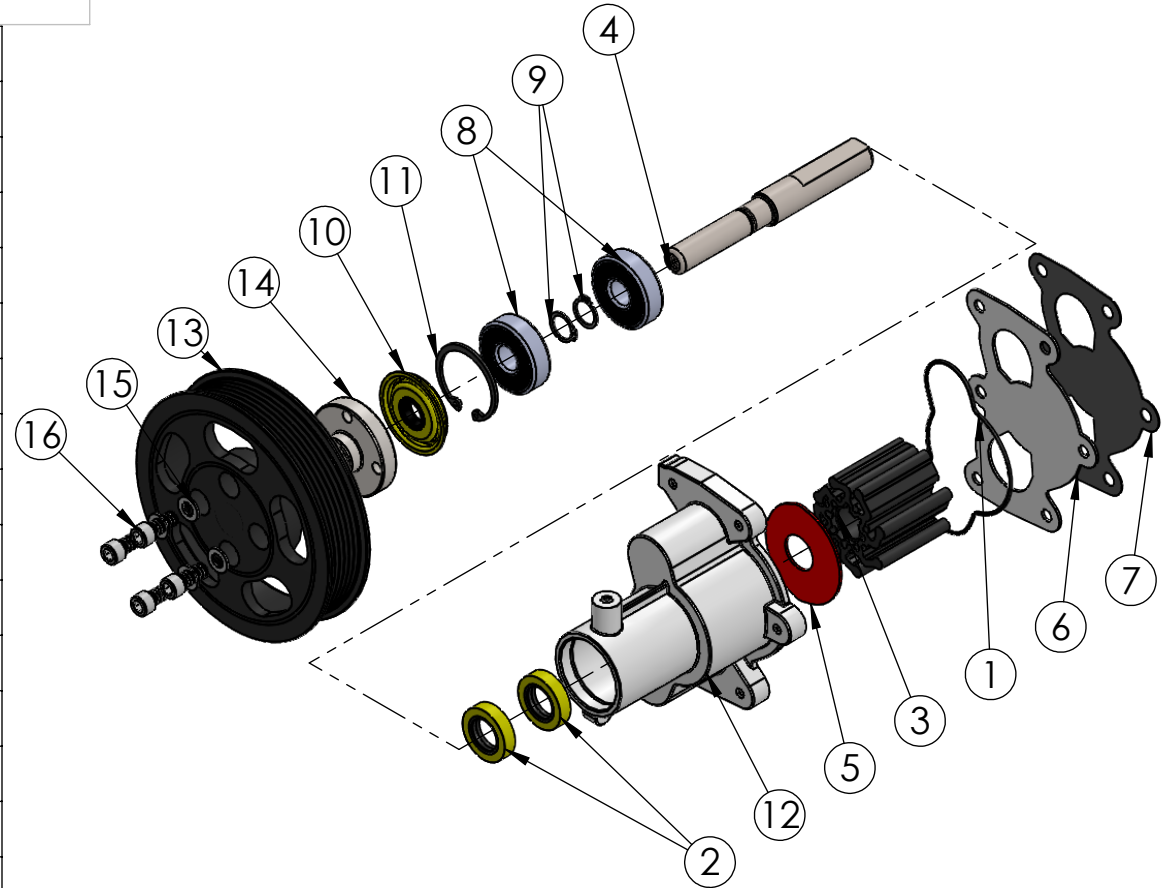

625-4131 PUMP WITH PULLEY COMES WITH ALL OF THEM

625-4132 BASE PUMP COMES WITH PARTS 1-13

625-4203 IMPELLER KIT COMES WITH 1,3,5,6 & 7

625-4133 MASTER REBUILD KIT COMES WITH 1,2,3,5,6,7,8,9,10 & 11

THIS DRAWING IS CONFIDENTIAL AND IS SUPPLIED ON EXPRESS CONDITION THAT IT SHALL NOT BE LENT, COPIED OR DISCLOSED TO ANY OTHER PERSON OR USED FOR ANY OTHER PURPOSE WITHOUT WRITTEN CONSENT OF HARDIN MARINE INC.. BREACH OF THIS CONTRACT WILL HOLD AND IT'S PRINCIPALS LIABLE FOR LOSS AND DAMAGES.